

Check valve NW 125-300 type F

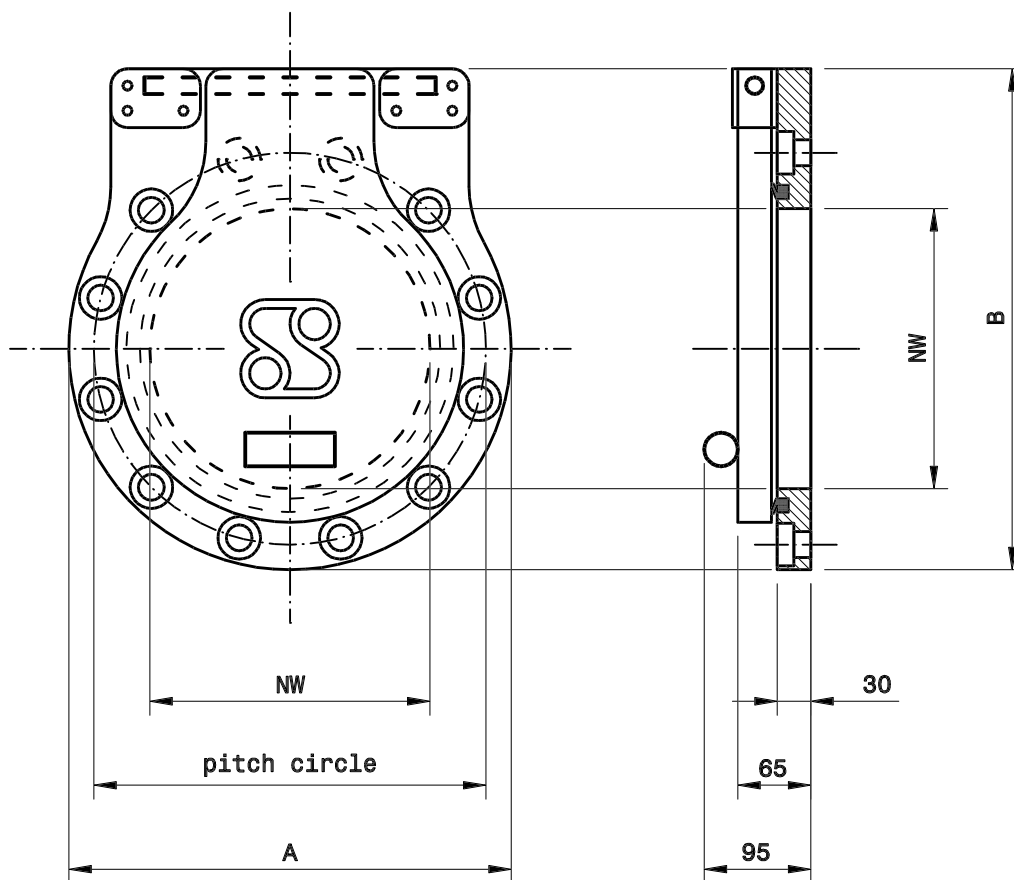

NW	A	B	pitch-circle	weight
125	Ø250	303	Ø210 (8x M16)	4 kg.
150	Ø285	378	Ø240 (8x M20)	4 kg.
200	Ø340	393	Ø295 (8x M20)	5 kg.
250	Ø395	478	Ø350 (12x M20)	7 kg.
300	Ø445	498	Ø400 (12x M20)	8 kg.

Material specification

Frame	- HDPE-300
Valve	- HMPE-500
Sealing	- EPDM
Valve axle	- Stainless AISI316
Bolts/nuts	- A4
Max. pressure	: 1 bar (14.5 psi)
Flanges	: PN 10, DIN 16963-4

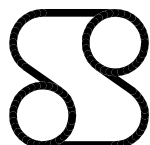
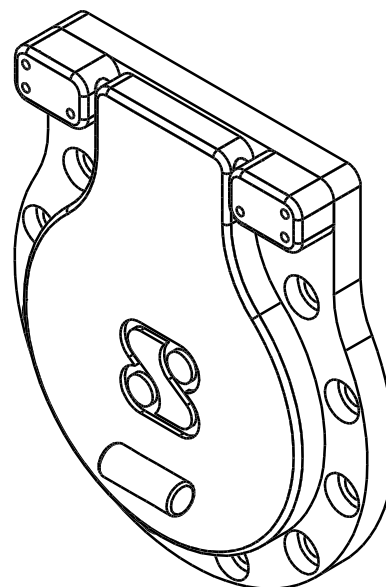

Synthesis BV - tel. +31 (0)321 380457
Koperweg 17 - 8251 KA Dronten

Check valve NW 400-600 type F

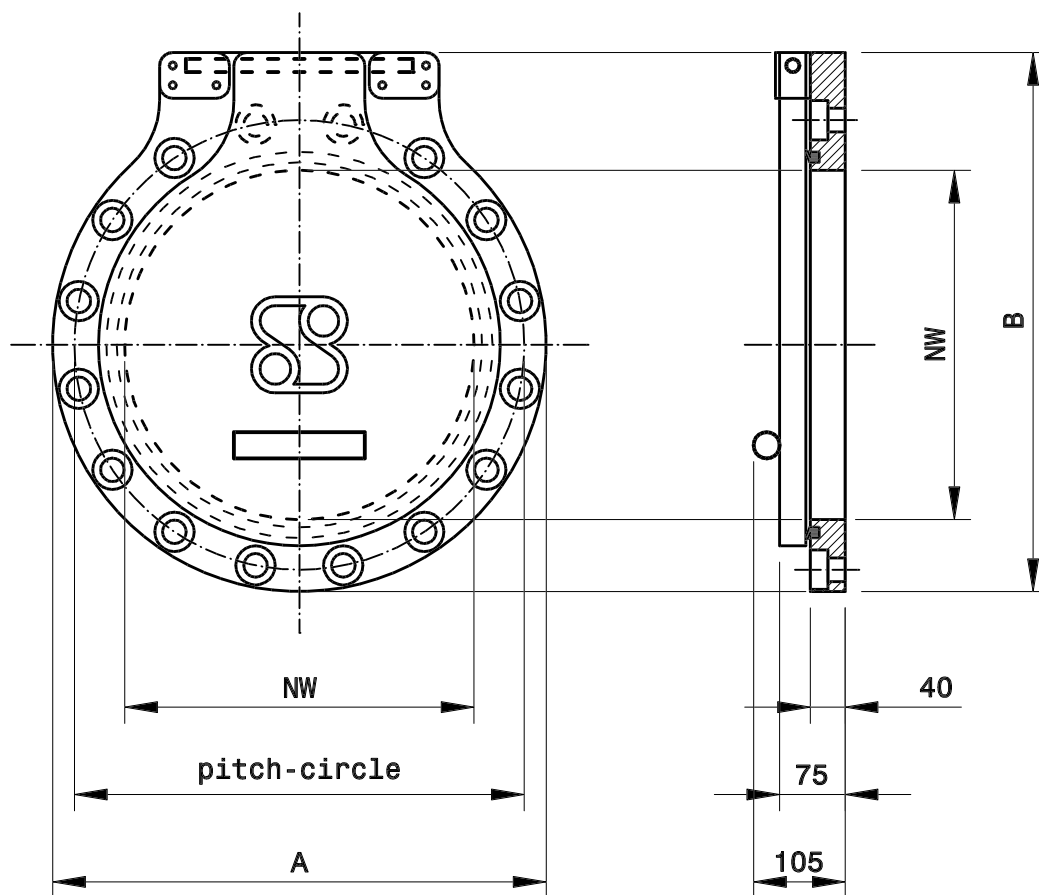

NW	A	B	pitch-circle	weight
400	Ø565	618	Ø515 (16x M24)	13 kg.
500	Ø670	723	Ø620 (20x M24)	17 kg.
600	Ø790	843	Ø725 (20x M27)	22 kg.

Material specification

Frame	- HDPE-300
Valve	- HMPE-500
Sealing	- EPDM
Valve axle	- Stainless AISI316
Bolts/nuts	- A4

Max. pressure	: 0.6 bar (8.7 psi)
Flanges	: PN 10, DIN 16963-4

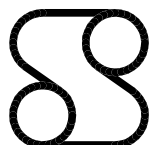
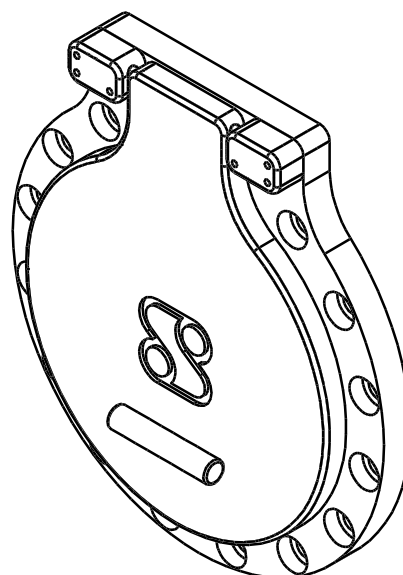

Synthesis BV - tel. +31 (0)321 380457
Koperweg 17 - 8251 KA Dronten

Check valve Ø700-Ø1000 type F

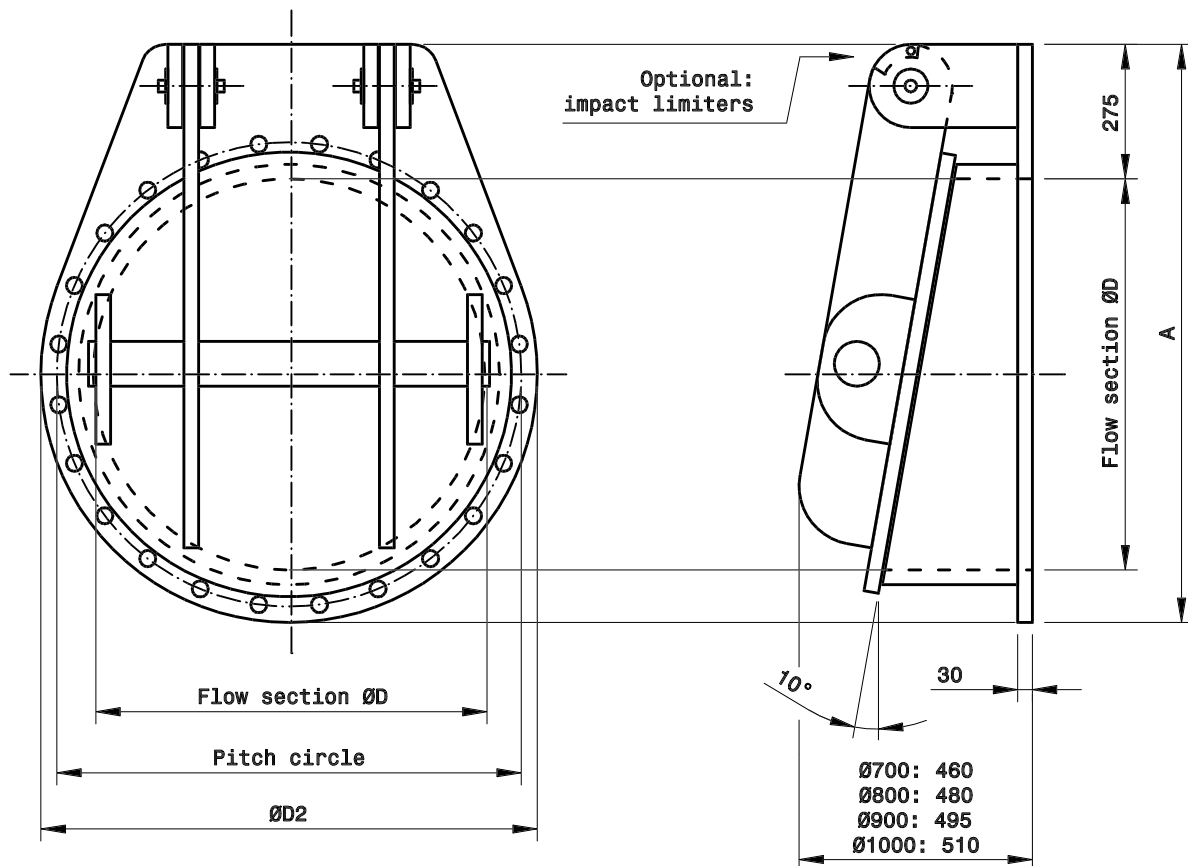

ØD	pitch circle	ØD2	A	weight
Ø700	Ø840 (24x M27)	Ø895	1073	55 kg.
Ø800	Ø950 (24x M30)	Ø1015	1183	60 kg.
Ø900	Ø1050 (28x M30)	Ø1115	1283	75 kg.
Ø1000	Ø1160 (28x M33)	Ø1230	1390	85 kg.

Material specification

Frame and valve - HDPE-300
Sealing - EPDM
Valve axles - Stainless AISI316

Supplemental data

Max. pressure : 0.6 bar (8.7 psi)
Flange : PN10 (DIN 16963-4)
An air bleed connection and impact limiters can be supplied when the valve is used as a pump discharge valve.

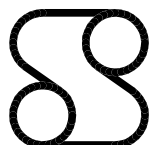
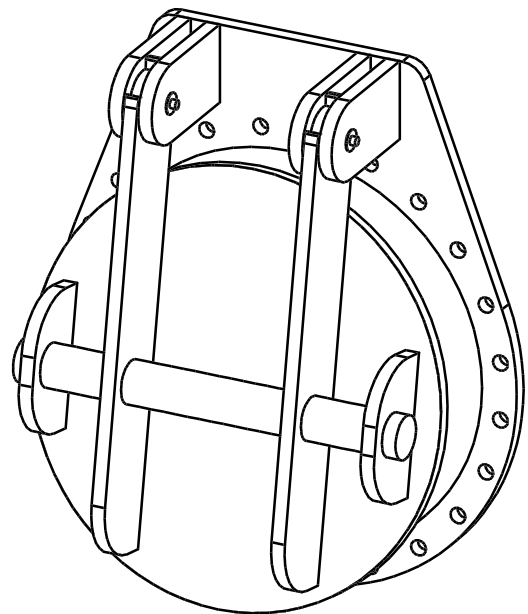

Synthesis BV - tel. +31 (0)321 380457
Koperweg 17 - 8251 KA Dronten